

President - Bob Fallier Vice Pres - George Michaels  
Treasurer - Robert Pawlak Editor - Roland Kelley  
Winterfest Chairman - Bob Fallier

Editor - Northeast Ntrak, 41 Easy Street, Lowell, MA 01850-1731, or  
e-mail: [NortheastNtrak@msn.com](mailto:NortheastNtrak@msn.com) Web Site - [www.northeastntrak.org](http://www.northeastntrak.org)



### President's Message Bob Fallier

From the President's Chair

This may be a short newsletter given the changing world climate. Not referring to the change from winter to spring, but the climate of participation and friendly gathering which has now been so completely changed. But we shall endure. Ours is a hobby of the ages for all ages and regardless of the availability of venues available to us, we will persist.

Yes, I am optimistic that like all things, this too, will pass.

Moving on. We had another work day in Amesbury where some small changes were made in the club trailer. Although there were only a few of us, none the less, we had a good time.

Many thanks to Jim Nolan for arranging the space and his personal schedule given the non-club related imperatives in his life. Besides working on the trailer we also discussed the October NMRA Hub Division show in Westford. As I've been talking about for some months, that show is intended to demonstrate operations and some good ideas came out of Amesbury. Thanks very much to Frank Dignan for his experience and suggestions.

To that end we are updating the club owned 2-foot modules which have turnouts between Yellow and Blue tracks. With these we should be able to run any freight on either track and switch it onto the Operations Modules and off the main lines. Using the pair of two-footers also allows a passing siding if needed.

Bob Pawlak has suggested several times that we keep train manifests short and practical, that we test continuity and functionality of all modules that will be used in this exercise. None of which is beyond what we should already be doing with our own modules. Assuming the October show is not postponed or cancelled, then I think we'll be well prepared if we spend some time in advance. We may want to consider a test layout in Amesbury before hand. The August Concord show may also provide us with a good practice run. Again, assuming that there will be an August show. As I'm sure you all know by now, the March Greenberg show has been cancelled.

As brought up in the annual meeting last year, we have been working to come up with a reasonable payment plan for members who pickup or return the trailer from/to Amesbury. Bob Pawlak spent quite some time Googling maps to calculate approximate distances driven and derived a

complicated formula with several variables and inverse algorithms to build a complex table.

Taking into account such factors as wind direction, temperature, and relative humidity, adding to those an inverse UV factor and wind chill index. He then postulated the miles per gallon (average), tongue weight (trailer tongue), tire pressure (cold and hot) and some other things that were completely over my head.

Then he simplified the whole thing for George and I to understand, sort of, requiring him to further extrapolate the final figures for payment to drivers. Fair and equitable as only the numbers meister could. Thank you Mr. Pawlak for your exhaustive efforts. We will review this as a group at the June picnic, the date is TBD.

As of this writing our local schools, churches, and library are closed. My weekly scout meetings are cancelled and I hope everyone has plenty of TP because for who knows what reason, it seems like TP has become the number 2 item on the short list, right behind (no pun intended) hand sanitizer. Now I have to ask, and trying to not insult anyone, when did we become so enamoured with a bottle of alcohol/glycerine/fragrance when we've all had soap handy for generations. As the surgeon general said last week: 20 seconds of soap and hot water is all the hand sanitizer you need. Plain old fashioned hand washing. There. That wasn't too complicated.

I'm not going to wax and wain over the virus. We've all heard quite enough about it and frankly it is beginning to sound more like the nightly news in the late sixties and early seventies. If you are old enough, and most of us are, then you recall the nightly casualty counts from Viet Nam. Sound familiar?

I will say this: the world will be a different place when this is all over. The economy will bounce back, it always does.

Our perspective of China and world relations with that country may be dramatically different given that this whole mess could have been contained a month earlier. But that's just my opinion.

Train shows will begin anew, although for a while attendance may be sparse. Being the dedicated, adventure seeking, and inspritional characters that we are; we will be there!

I wish I had more to say about shows or events or any good news, but like everything else, we are just temporarily on hold. (continued on page 3)

**T-TRAK Train Show Schedule**  
**2020 & 2021**

If you wish to be part of the T-Trak layout contact Fay Chin Show Coordinator at e-mail [nttrak@gmail.com](mailto:nttrak@gmail.com)

**March 28 & 29, 2020, Greenberg's Great Train Show**  
**Shriners Auditorium**  
99 Fordham Road Wilmington, MA  
Sat & Sun 10-4pm

**CANCELED**

**April 26, 2020, Hooksett Lions Club Train Show**  
Crawley Middle School, Hooksett, NH  
Sun 10-3pm

**July 17-19, 2020, NMRA Convention, National Train Show**  
St Louis, MO

**August ??, 2020, Concord Model Railroad Club**  
Everett Arena, Loudon Road Concord, NH  
10:00 - 3:30 pm

**September 20, 2020, Old Colony Model Railroad Club**  
Taunton Holiday Inn, Taunton, MA  
Sun 10 - 3:30pm

**October 17 & 18, 2020, Nashua Valley Railroad Association**  
Boxborough Regency Hotel, Boxborough Ma  
Sat & Sun 10-4pm

**October 9 & 12, 2020, NMRA NEC Convention**  
Westford MA

**October 24 & 25, 2020, Southshore Model Railway Club**  
19 Fort Hill St. Hingham MA  
Sat 9-4, Sun 10-4pm

**November ??, 2020, Wellesley Community Center**  
219 Washington St. Wellesley, MA  
10am - 3pm

**November 21 & 22, 2020, Greenberg's Great Train Show**  
Shriners Auditorium, 99 Fordham Road Wilmington MA  
Sat & Sun 10-4pm

**December 5 & 6, 2020, New England Model Train Show.**  
NMRA HUB, Best Western Royal Plaza Trade Center  
Marlborough, MA  
Sat 10am - 5pm, Sun 10-4

**January 30 & 31, 2021, Amherst Railway Society Railroad Hobby Show**, Eastern States Exposition Fairgrounds, West Springfield MA  
Sat 9 - 5pm, Sun 10-5

**March 13 & 14, 2021, Southshore Model Railway Club**  
19 Fort Hill St. Hingham, MA  
Sat 9-4, Sun 10-4pm

**March ??, 2021, Greenberg's Great Train Show**, Shriners Auditorium, 99 Fordham Road Wilmington, MA  
Sat & Sun 10-4pm

**2019-2020 NENTrak SHOW PARTICIPATION SCHEDULE**

**March 28-29, 2020 Great Train Expo**, Shriners Auditorium, Wilmington, MA  
Set-up: Fri 1:00pm - 6:00pm - Sat 7:30am  
Show Sat 10:00am to 4:00pm - Sun 10:00am to 4:00pm  
Coordinator: Frank Dignan - 508-866-9660

**April 26, 2020 Hooksett Lions Club**, Cawley Middle School, Hooksett, NH  
Set-up: 8:00am - Show 10:00am to 4:00pm  
Coordinator: Russell Putnam - 603-835-6952

Show Dates **Subject to Change**...Check Newsletters for Updates. Please check schedule for errors and send up dates to Roland at: [northeastntrak@msn.com](mailto:northeastntrak@msn.com) Thanks for

**More pictures of Bob's garden railroad.**

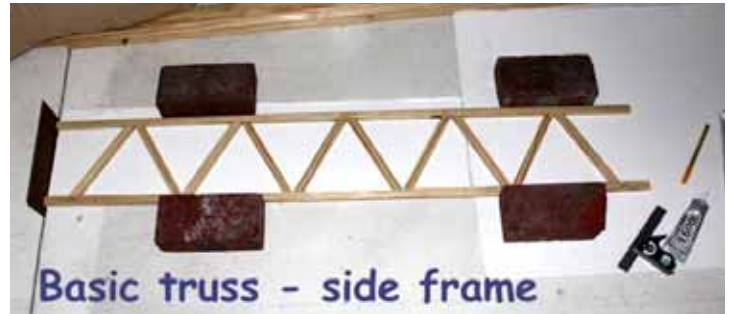

(continued from page 1)  
Well, maybe not all of us.

In the meanwhile work continues on the Stoneman & Turkey Divide Railroad. I've mapped out what should be about a 200 foot expansion of the railroad and this will be an almost virtually separate branch with two connection points to the existing track.



Conduit for the main power feeds.

The general plan is to have some staging near my basement door, cross the lawn into the woods, head south into another loop toward Sanders Village. From Sanders it will connect to the main line. The difficult part will be traversing a sloped area with a 2% grade over 50 feet.



Before new trackwork was begun I built several truss bridges and a number of trestle bents. Although 17 of the 19 bents currently installed are for looks only, there is a ten foot span at the far end of the existing elevated track where the inherent strength of a truss became evident when I began to glue, clamp, and screw the first of two 60 inch trusses in place. The midpoint of the long span was beginning to sag and it is now fully supported by a pair of bents and the two truss sections. And it all actually looks pretty good. Not accurate, and Bob P will probably have small fits, and expound on the virtues of doing it this way or that. Mr. Bob, your input and suggestions are quite welcome as I will have more to build. Meanwhile, my intent is to give the elevated section a broad "look" of reality, rather than being mechanically exact.



Nephew Trenching for conduit



Truss - 10 foot span fully supported by truss & bents.



Truss bridges 54, 48, 54 inch.

With some luck and a lot of work, the Rangeley Lakes branch may even be operational by June.

Happy Rails to all!  
Bob

## **Bob Fallier's G Scale Private Car.**

I took out two rows of seating (below picture). Put carpet down on one floor, wood planking on the other.



Wall paper and wood paneling on the bulkheads, pictures. Built the bed and folded the quilt to match.



Sheer curtains behind the couch (pain in the butt!!!) 3 sofa cushions



Tea set on a table, Candle sticks from 5 small parts each.



Working lighting end to end. Decorated the WC with mirrors and wall paper



. Made the chandelier from wire and beads. And who knows what else.



I think I put roughly 80-90 pieces together (cushions only count as 1 each)



The "flooie" is a cast resin figure - so-so. The other is from Preiser - very detailed. Probably spent \$150 in parts and pieces to make this thing.